

Slide Screen

INSTALLATION

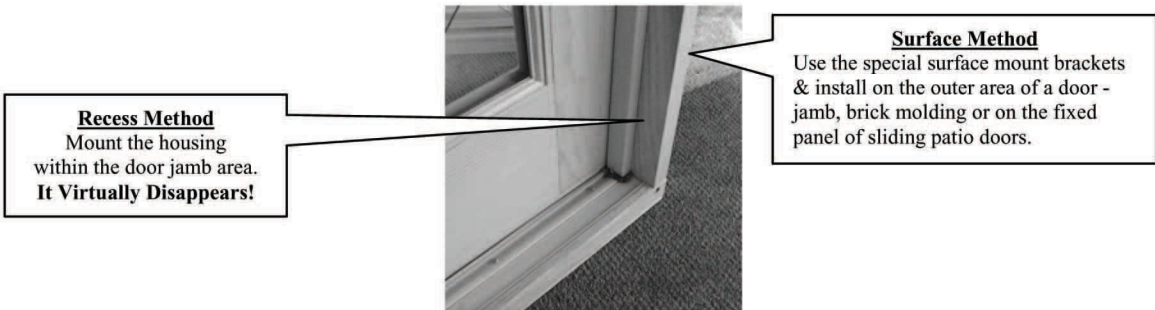

* Installation methods may vary depending upon the door design and configuration. The following instructions will guide you through the most common applications. Now, you are ready to begin.

- 1 – Set the housing in place and mark a spot on the door jamb where you want the housing to be positioned, making sure the door does not interfere with the handles on the disappearing screen.
- 2 – Measure approximately 20” inches from the top and bottom and mark for the clips (Note: the lip side of the clips should face away from the door). Fasten the mounting clips to the door with screws.

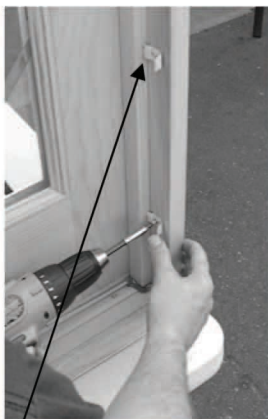

Recessed Mount
(Standard Clip)



Surface Mount
(Alternate Surface Mount Clips)

Sliding Patio Door Mounting
Typically mount the housing so that the rear most side rests approximately 1-1/2” in on the stationary door panels center mullion